

PLATES - PLAQUETTES - PLATEN

Plates

Material : Red copper or tinned copper
Other sizes on requests.

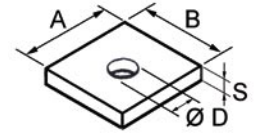
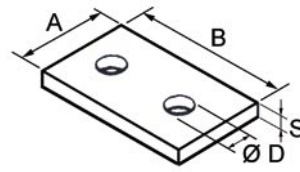
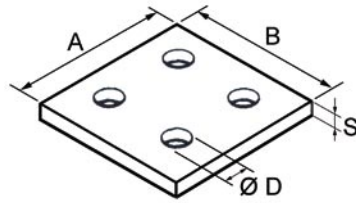
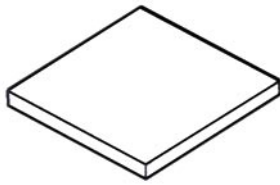

Art.	A X B x S	Ø D	Fig.
	...X...X... mm mm	
According to customer's drawing Suivant plan client Volgens plan klant			

Plaques

Matière : Cuivre rouge ou cuivre étamé.
Autres dimensions sur demande.

Platen

Materiaal : Rood koper of vertind koper.
Andere afmetingen op aanvraag.

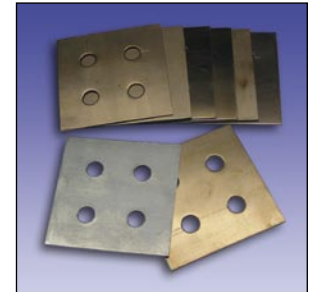

Bi-metallic plates

Material : Copper Aluminium
Other sizes on requests.

Plaques bi-métalliques

Matière : Cuivre-Aluminium
Autres dimensions sur demande.

Bi-metalen platen

Materiaal : Koper-Aluminium
Andere afmetingen op aanvraag.

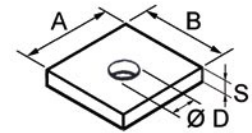
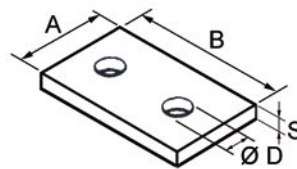
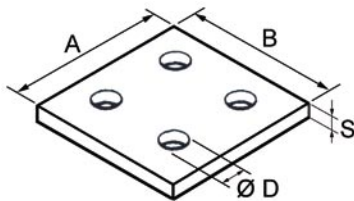
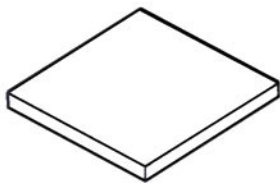

Plates - Plaques - platen			
Art.	A X B x S mm	Ø D	Fig.
	... x ... x ... mm	... mm	...
According to customer's drawing Suivant plan client Volgens plan klant			



Washers - Rondelles - Ringen				
Art.	M	d1	d2	S
Bi-M3	3	8	3,5	1
Bi-M4	4	10	4,5	1
Bi-M5	5	12	5,5	1
Bi-M6	6	15	6,5	1
Bi-M8	8	18	8,5	1
Bi-M10	10	22	10,5	1,5
Bi-M12	12	25	13	2
Bi-M12/b	12	28	13	2
Bi-M16	16	35	17	2

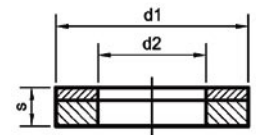

Flat strips in coils

Material : Red copper or tinned copper
Other sizes on requests.

Méplats en rouleaux

Matière : Cuivre rouge ou cuivre étamé.
Autres dimensions sur demande.

Blad in rollen

Materiaal : Rood koper of vertind koper.
Andere afmetingen op aanvraag.

Art.	Width Largeur Breedte	Thickness Epaisseur Dikte
	mm	mm
	20 to 125	1 to 12
According to customer's drawing Suivant plan client Volgens plan klant		

