

# Data Sheet CS/P 50

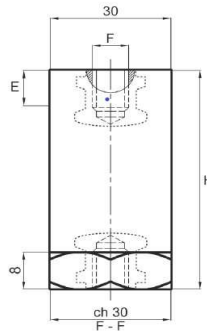

<b>Material</b>	Polyester material reinforced with fiberglass BMC RF 3/20
<b>Operating Temperature</b>	°C: - 40° + 130°
<b>Fire reaction</b>	UL94-V0 File Nr. E205214
	HL2 according to the EN45545-2
<b>Thread Material</b>	Galvanized Steel
<b>H</b>	50 mm
<b>E</b>	M6 : 12 mm / M8 : 13 mm / M 10 : 13 mm
<b>Tightening Torque</b>	M6 : 10 Nm / M8 : 22 Nm / M 10 : 24 Nm
<b>Operating Voltage</b>	1500 V
<b>A.C. surface flashover voltage</b>	10 KV
<b>A.C. internal flashover voltage</b>	35 KV
<b>Tensile stress</b>	900 DN
<b>Cantilever stress</b>	200 DN
<b>Compressive stress</b>	4.000 DN
<b>Twisting stress</b>	1,3-2,6 DN x mm
<b>Package</b>	48 pcs
<b>Weight of package</b>	4,50 kgs